

Instructions

Gearbox Mount

N.B: This instruction sheet should be used in conjunction with the workshop manual and proper safety procedures followed.

Contents - Mount 67897 x1
 - 7/16 bolt x2
 - Spring washer x2
 - Flat washer x4

Note - mount supplied with 3 holes - your vehicle will use either the centre bolt or the 2 outer bolts. (use supplied bolts and spring washers)

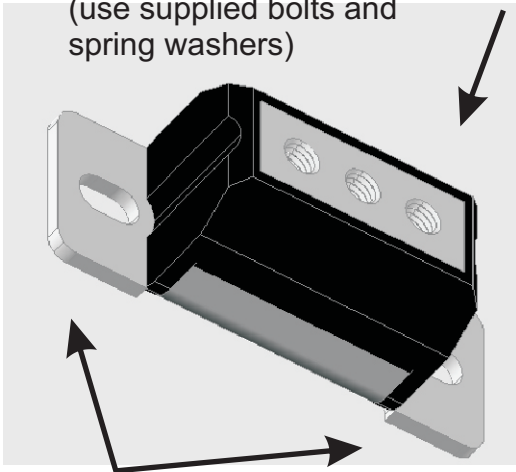

Supplied flat washers not required if OE bolts are flange style

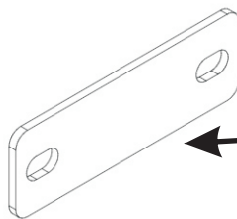

Place supplied sandwich plate between gearbox and mount

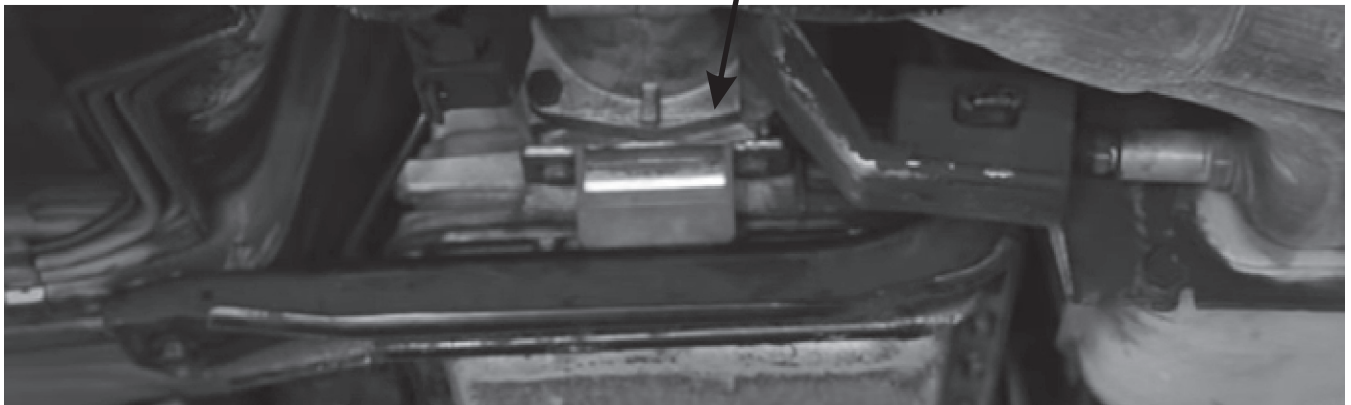

- Raise vehicle evenly and safely support.

Never rely on a Jack only

- Lift/support gearbox just enough to remove cross-member. Use Timber to prevent damage.

- Un-bolt original mount and proceed to place new mount in position.

NOTE - use supplied sandwich plate between gearbox and new mount.

- Bolt up mount - re-use OE bolts for gearbox Use supplied bolts/washers for cross-member.

- Tighten and road test.

- Re-check all bolts after 100Kms travelled.

N.B: It is recommended that a licenced workshop or tradesperson carry out the above procedure and that workshop manual and relevant safety procedures are followed in addition to the above.