

Installation Guide

Trailing Arm - Rear Bush Kit

Z 5046

Suits: Ford Laser KF/KQ 90 - 02
Mazda 323 BA/BJ 94 - 03
Eunos 30X, MX3 92 - 96

(Always refer to the current catalogue for complete application listings)

N.B: This installation guide should be used in conjunction with the workshop manual.
All fastener torque settings should be adhered to.

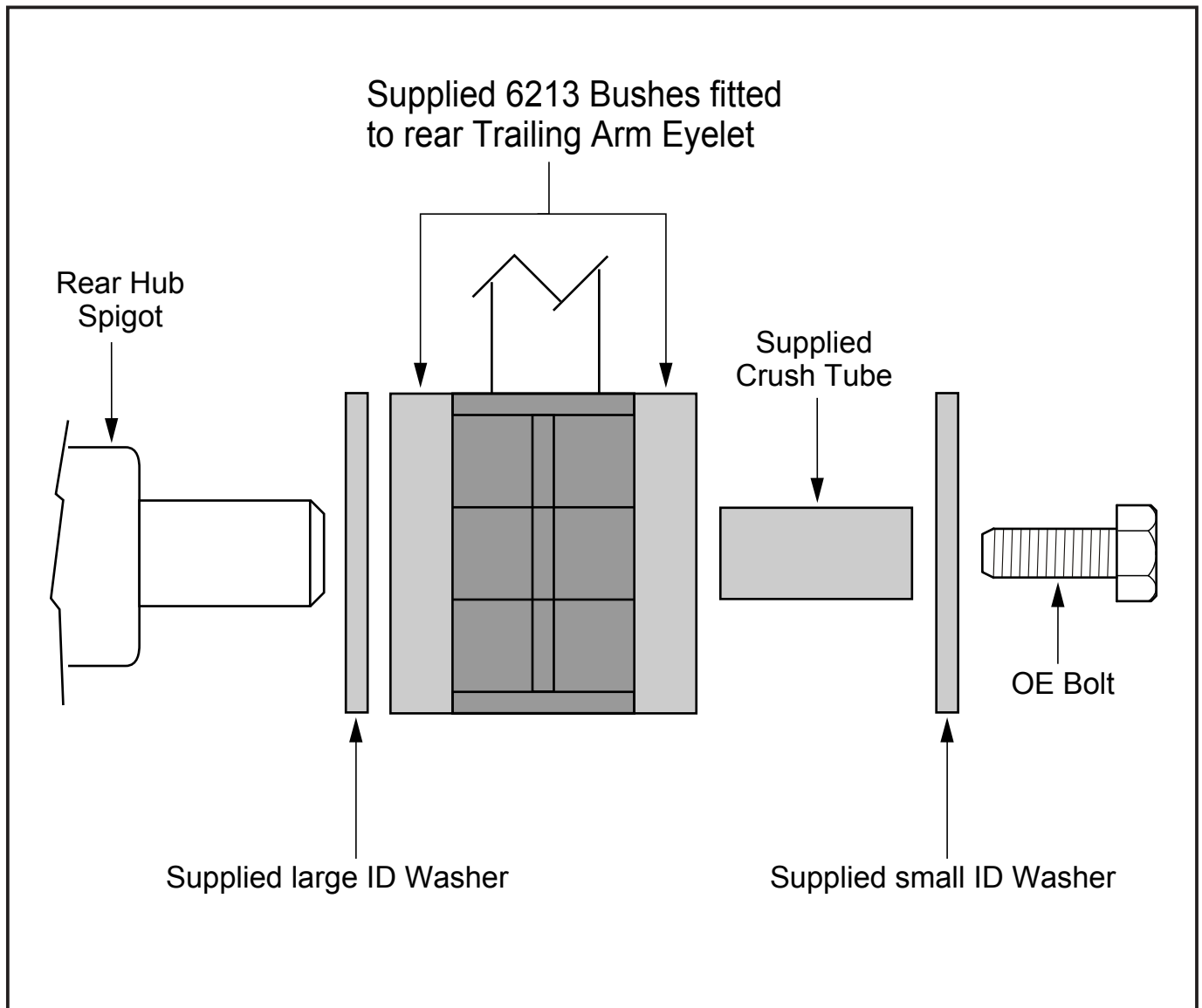

N.B: It is recommended that a licenced workshop or trades person carry out the above procedure and that workshop manual and relevant safety procedures are followed in addition to the above.