

Nolathane[®] Update.

96-1NO

COMMODORE STRUT MOUNTS

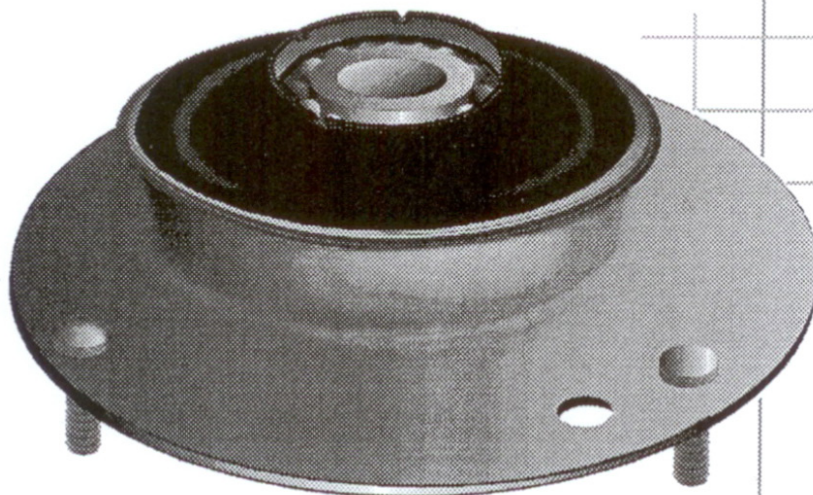

Part Number

44016

Adjustable

Part Number

44017

Standard

Many of the VN Commodore and all of the VP and VQ Series had a different strut mount assembly from the early Commodore models.

For this series of vehicles a left and right handed mount was used. This meant that the existing Nolathane strut mount, 44000 (adjustable) and 44001 (standard), could not be fitted as there was not enough adjustment available.

Nolathane now have available two new kits which fit the following:

Holden Commodore	VN, VG	- with standard suspension	6/9/89 on
		- with FE2 suspension	15/6/89 on
Holden Commodore	VP, VQ		9/91 - 12/93